



Ramsey Gateway Highway 10 Project

Public Meeting Summary | April 12, 2023

~70 OPEN HOUSE ATTENDEES

Thank you to everyone who attended the April 12, 2023 public meetings! Two in-person meetings were held at Ramsey City Hall, one for business and property owners and the other for the general public. Information shared included the final project design and plans for construction including staging, detours, and communications. Materials and feedback opportunities were also provided online.

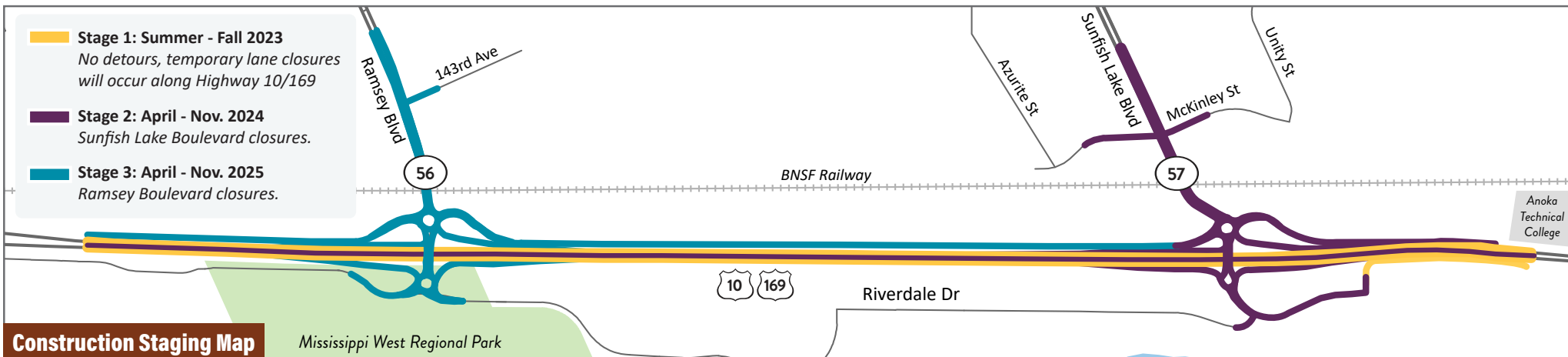

Summary of Questions and Comments Heard

How will local access be maintained during Stage 2 of construction?

During Stage 2, the Sunfish Lake Blvd intersection will be closed. Traffic access to the north of the BNSF railway will be provided by the regional detour route. (see map to the right) Traffic access to the south of Hwy 10/169 will be provided along Riverdale Dr, which will have temporary traffic signal access to and from Hwy 10/169 near Anoka Technical College and at Ramsey Blvd.

How will local access be maintained during Stage 3 of construction?

During Stage 3, the Ramsey Blvd intersection will be closed. The newly completed Sunfish Lake Blvd interchange will provide local access. Additionally, frontage road construction will occur. Business access will be maintained at all times during completion of the frontage road.

What will traffic routes along Highway 10 be like during construction?

Highway 10/169 will be able to accommodate 2 lanes of traffic in each direction throughout the duration of construction.

Aside from questions about construction staging and access routes, there was much support for the final design, relief that two traffic lanes in each direction will be maintained on Hwy 10/169, and excitement for construction to begin!

Review detailed staging maps like the one below on the virtual open house webpage!

Stage 2A/2B Construction: April - Sept. 2024

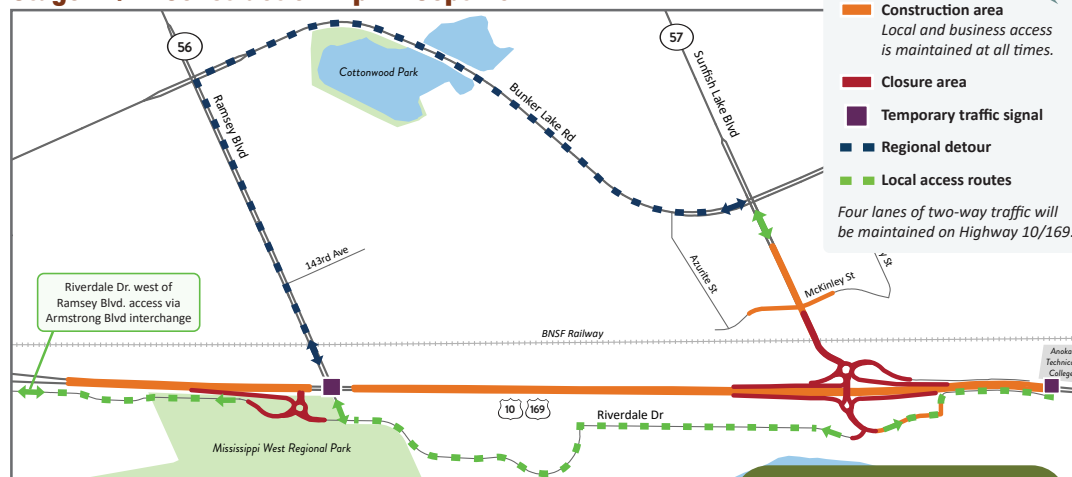

Draft Subject to Change

Disclaimer: Staging locations and dates subject to change. This document is a draft, subject to change, and is provided for information only. This draft document does not commit Anoka County to construct the project as shown in part or in whole. The actual project plan may differ from this draft plan. Contact Anoka County Highway Department with any questions: 763-324-3100.

See more on the back page of this summary!



Ramsey Gateway Highway 10 Project

Public Meeting Summary | April 12, 2023

~70 OPEN HOUSE ATTENDEES

Final Design Renderings

Bird's eye view of Ramsey Boulevard looking Northwest



Check out the final design fly-through video on the project website!

What's Next?

The project team is currently finalizing plans for Stage 1 of construction, which is anticipated to begin Summer 2023. During this stage, temporary lane closures will occur along Highway 10/169. Business and local access will be maintained at all times.

Visit the project website to review the construction staging, detours and local access routes on our interactive comment map and sign up for project updates!



AnokaCountyRamseyGateway.com



Multi-use trail / lighting details for the Ramsey Blvd bridge



Roundabout center median landscaping details



Bridge over Hwy 10 / 169 design details

Draft Subject to Change
Disclaimer: These drawings represent a potential design concept only. This document is a draft, subject to change, and is provided for information only. This draft document does not commit Anoka County to construct the project as shown in part or in whole. The actual project plan may differ from this draft plan. Contact Anoka County Highway Department with any questions: 763-324-3100.



Anoka County
MINNESOTA

Respectful. Innovative. Fiscally Responsible

